

ADMINISTRATIVE SKETCH 1

ILLUSTRATION OF THE EXTENT OF RESERVE LANDS THAT WILL BE SUBJECT TO THE LAND CODE OF THE CHIPPEWAS OF KETTLE AND STONY POINT FIRST NATION UNDER THE FIRST NATIONS LAND MANAGEMENT ACT.
(excluding mines & minerals)

**CHIPPEWAS OF KETTLE AND STONY POINT FIRST NATION
KETTLE POINT INDIAN RESERVE No. 44**
PART BEING ADJACENT TO THE GEOGRAPHIC TOWNSHIP OF BOSANQUET
AND PART WITHIN THE GEOGRAPHIC TOWNSHIP OF BOSANQUET
MUNICIPALITY OF LAMBTON SHORES
COUNTY OF LAMBTON
PROVINCE OF ONTARIO

PREPARED ON THE 20th DAY OF JANUARY 2014 BY R.A. FLIGG., O.L.S., C.L.S.

SCALE: 1:10,000
100 0 100 200 300 400 500m

Reserve boundary shown thus ...

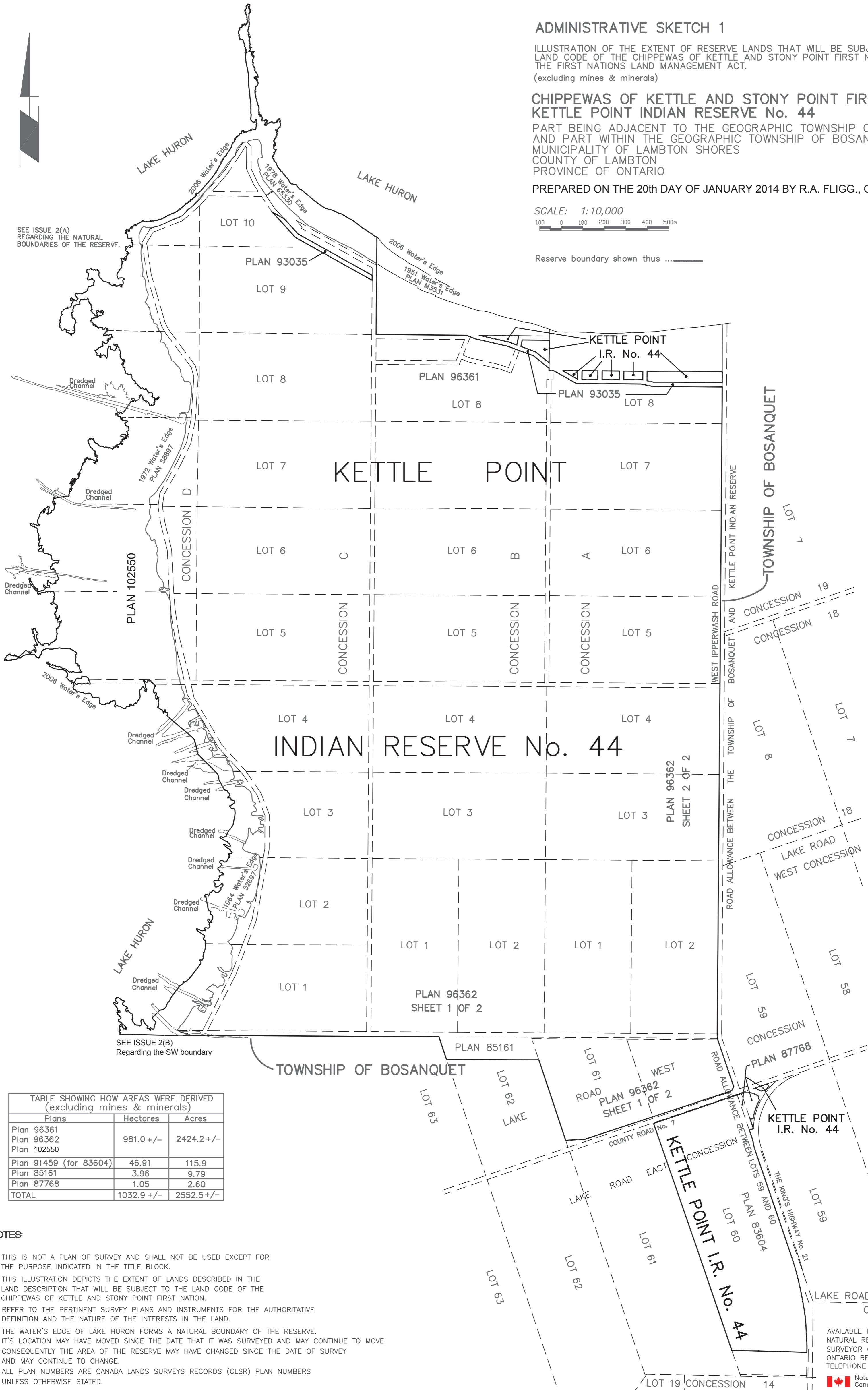

SEE ISSUE 2(A)
REGARDING THE NATURAL
BOUNDARIES OF THE RESERVE.

SEE ISSUE 2(B)
Regarding the SW boundary

TABLE SHOWING HOW AREAS WERE DERIVED (excluding mines & minerals)		
Plans	Hectares	Acres
Plan 96361 Plan 96362 Plan 102550	981.0 +/-	2424.2 +/-
Plan 91459 (for 83604)	46.91	115.9
Plan 85161	3.96	9.79
Plan 87768	1.05	2.60
TOTAL	1032.9 +/-	2552.5 +/-

NOTES:

- THIS IS NOT A PLAN OF SURVEY AND SHALL NOT BE USED EXCEPT FOR THE PURPOSE INDICATED IN THE TITLE BLOCK.
- THIS ILLUSTRATION DEPICTS THE EXTENT OF LANDS DESCRIBED IN THE LAND DESCRIPTION THAT WILL BE SUBJECT TO THE LAND CODE OF THE CHIPPEWAS OF KETTLE AND STONY POINT FIRST NATION.
- REFER TO THE PERTINENT SURVEY PLANS AND INSTRUMENTS FOR THE AUTHORITATIVE DEFINITION AND THE NATURE OF THE INTERESTS IN THE LAND.
- THE WATER'S EDGE OF LAKE HURON FORMS A NATURAL BOUNDARY OF THE RESERVE. IT'S LOCATION MAY HAVE MOVED SINCE THE DATE THAT IT WAS SURVEYED AND MAY CONTINUE TO MOVE. CONSEQUENTLY THE AREA OF THE RESERVE MAY HAVE CHANGED SINCE THE DATE OF SURVEY AND MAY CONTINUE TO CHANGE.
- ALL PLAN NUMBERS ARE CANADA LANDS SURVEYS RECORDS (CLSR) PLAN NUMBERS UNLESS OTHERWISE STATED.

AVAILABLE FROM:
NATURAL RESOURCES CANADA
SURVEYOR GENERAL BRANCH
ONTARIO REGIONAL OFFICE
TELEPHONE NO. (416) 973-1006
Natural Resources Canada / Ressources naturelles Canada